

DROP&GO TECHNOLOGY

Bindomatic® 9000 System

Spend only 3 seconds at the machine to bind 10 documents



DROP&GO TECHNOLOGY DRAMATICALLY IMPROVES YOUR WORKFLOW

We've redefined document binding efficiency with the Bindomatic® 9000 System. Designed with the high-end user in mind, the 9000 boasts the capacity to process and thermally bind a document every two seconds.

What truly sets it apart from all others is its Drop&Go Technology. Batch-feeding documents into the machine frees the operator to work in parallel, while simultaneously binding documents. You simply Drop&Go!

Thanks to its intuitive simplicity, ease of use, and binding speed, the new 9000 System is the ideal binding solution for office/corporate walk-up print stations, as well as volume demanding CRD or commercial print environments.

DOCUMENT SIZE

A4 — portrait bound orientation

SYSTEM CAPACITY

From 1 to 150 sheets of 80 gsm paper.

Performance is subject to user environment.

DOCUMENT SPINE WIDTH

from 1.5 to 15 mm

MACHINE DIMENSIONS

L 746 x W 645 x H 435 mm

MACHINE WEIGHT

48 kg

POWER SUPPLY

230V, 50/60Hz



BONUS! System includes additional desktop unit for editing

The Bindomatic® 9000 is available for lease.
Contact your Binding Efficiency Expert for details.



BINDOMATIC®
BINDING EFFICIENCY EXPERTS

HOW DROP&GO WORKS

360°
VIEW

A. OVERHEAD

Step-by-step, easy to follow instructions are on every Bindomatic goo.

Once pages are placed in the automatic cover size selector, the machine will show the correct cover spine width to use on the display.



Insert unbound documents and covers into the goo. The machine moves your documents to the thermal binding belt.

B. BACK AND RIGHT SIDE

Smooth panels allow the goo to be conveniently placed in a corner to save floor-space.



C. FRONT AND LEFT SIDE

Documents are transported through the binder. The fully automated thermal binding process includes heating/cooling of glue and paper jogging/aligning and is completed in 2 minutes.

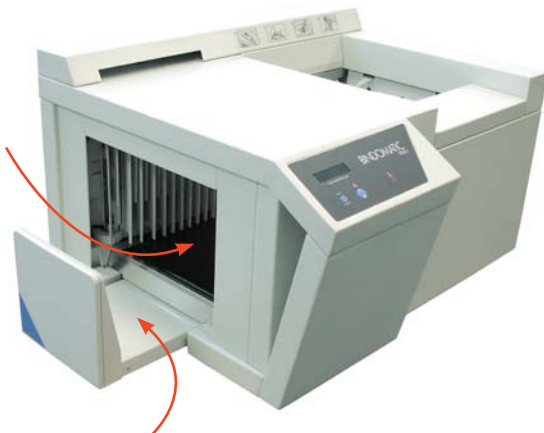

The cooling tray expands to accommodate documents as they emerge; bound and ready to use.

1. Insert one set of papers to be bound in the automatic cover size selector. The display will show the correct cover spine width to use.

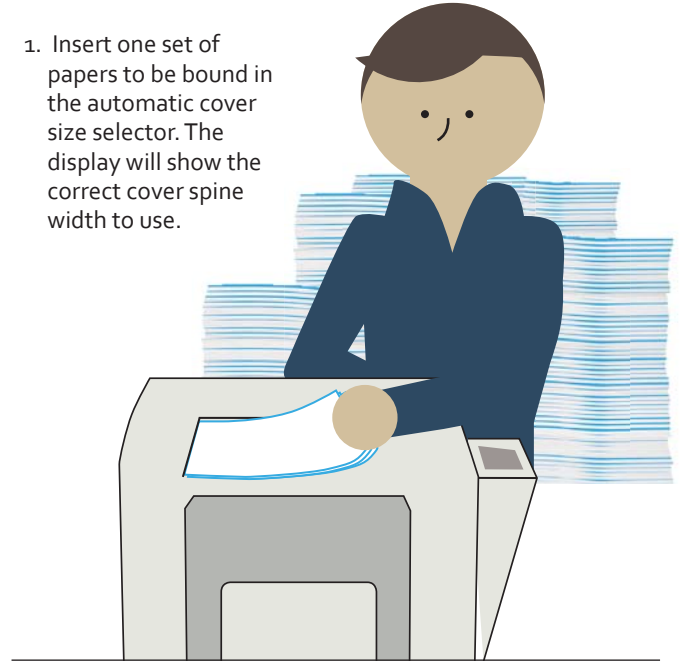

2. Place document pages in a Bindomatic cover, with the correct spine size, and align.

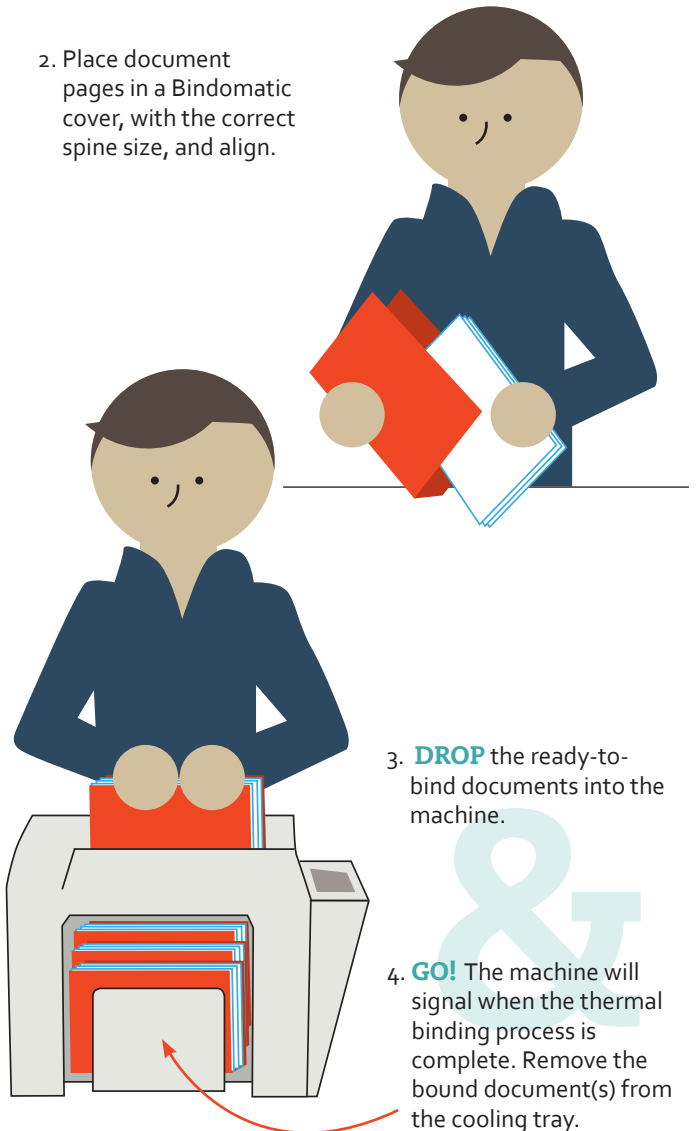

3. **DROP** the ready-to-bind documents into the machine.

4. **GO!** The machine will signal when the thermal binding process is complete. Remove the bound document(s) from the cooling tray.